

Spence Doors Technical Detail

Heavy Duty Metal Cavity Units

TECH SHEET 1 | PRESS METAL DOOR FRAMES

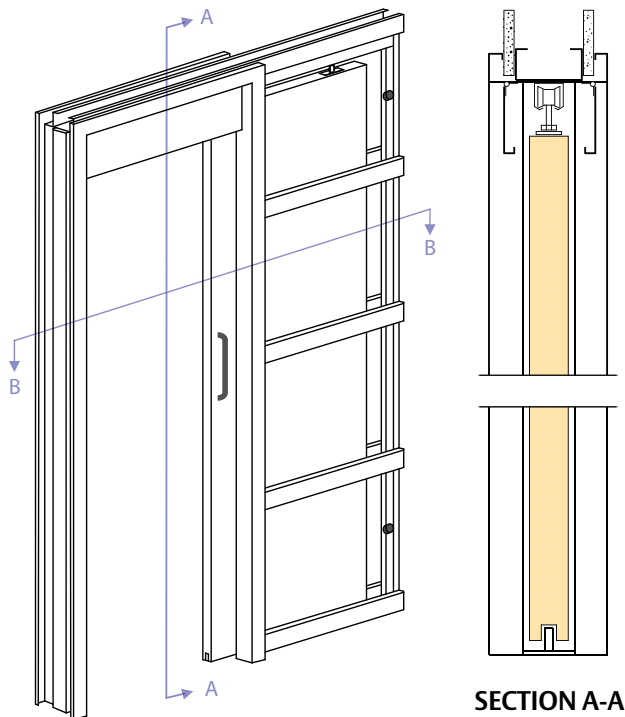

Spence heavy duty cavity pocket used in nursing homes and high use applications.

- Heavy duty cavity sliding door units
- Designed for domestic, commercial and industrial applications
- Frame profiles are manufactured to suit wall thickness (min stud size 76mm)
- Custom made to doors sizes
- Units fabricated from 1.1 or 1.5mm zincanneal
- Welded and shop primed ready for installation

Standard Track and Carrier.

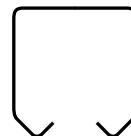

Twin Track
Steel track
Galvanised

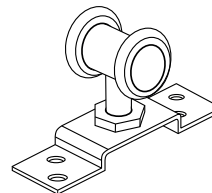

Carrier
2 Nylon Wheels
Quiet operation
Carries 90 kg

SECTION B-B

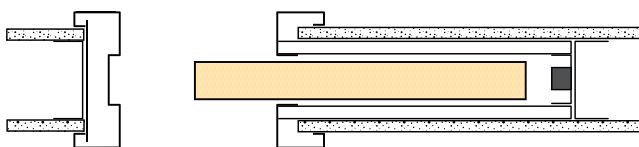

DOOR FITTED PROUD OF JAMB

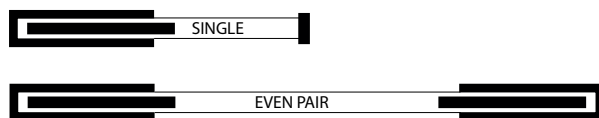

Door protrudes 45mm from split jambs when fully open.

DOOR FITTED FLUSH WITH JAMB

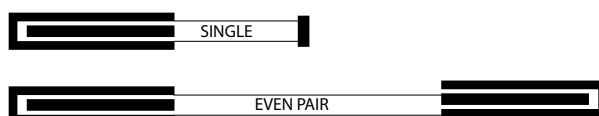

Door finish flush with the jambs when fully open.

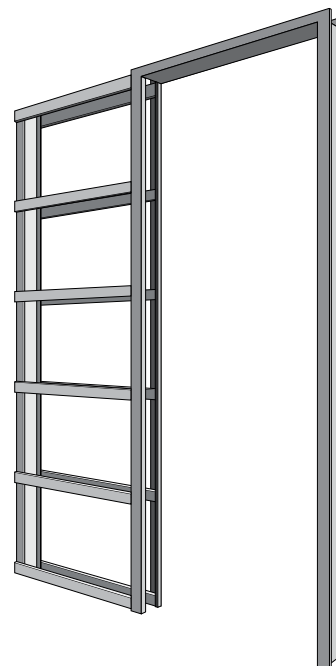

Spence Doors Technical Detail

Heavy Duty Metal Cavity Units

TECH SHEET 1 | PRESS METAL DOOR FRAMES

Installation diagram

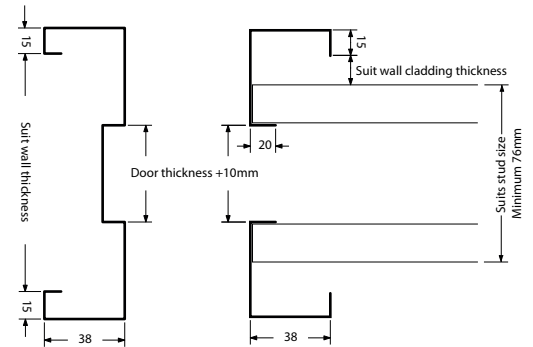
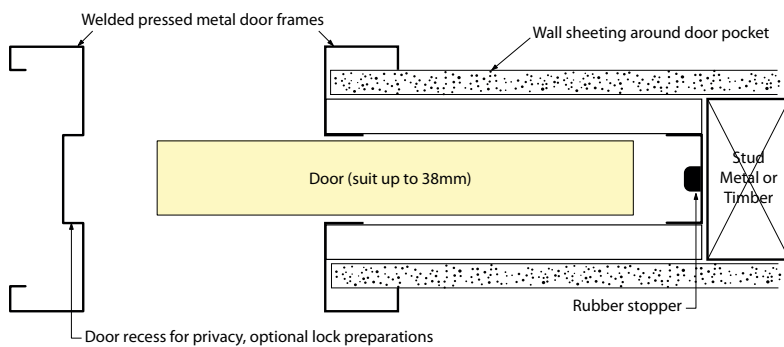

Standard Cavity Units designed to suit:

- Clearance under the door of 20mm adjustable to 6mm
- Direct mounting to finished floor surface

Cavity Unit supplied with:

- Pressed metal frame and pocket designed for cavity units
- Galvanised steel track
- Complete packet of fittings including rollers, bracket, guide (optional) and fixing screws
- Hinged pelmet (optional)

Excludes door and door furniture.

IMPORTANT

- Fix the wall cladding with glue. Do not penetrate rails with screws
- Ensure the track is level and is resting on track platform
- Do not remove 'temporary' spreader bars until ready to insert door. It is easier to install and clad with spreader bars in place
- The cavity clearance are at a minimum. Only seasoned doors of good construction should be used to avoid scraping caused by door warping

