

Spence Doors Technical Detail

Radiation Doors (Lead Lined Doors)

TECH SHEET 7 | PRESS METAL DOOR FRAMES

Single Doors

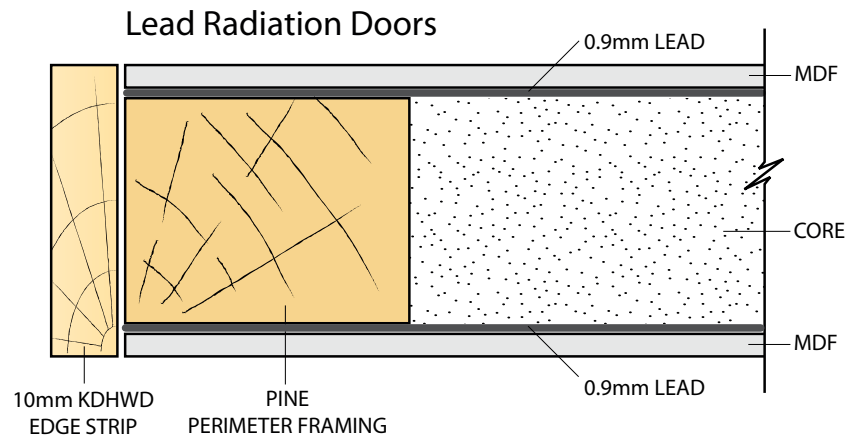

Rebated Double Door

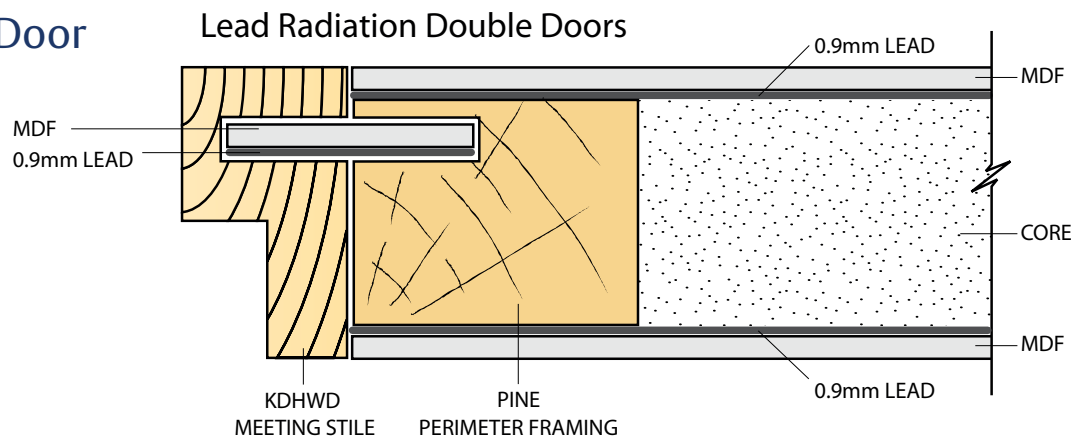

*Lead lined doors require a minimum covering of 5kg/m² lead sheet on each side of the core. Additional layers can be added for increased performance.

Typical Lead Weights:

- 5kg/m²
- 10kg/m²
- 20kg/m²
- 30kg/m²
- Up to required performance.